

Flange Style

Part Number	Drive Size	A inch/mm	B inch/mm	D inch/mm	L inch/mm	Washer OD inch/mm
RLE-4-F	E4	.146/3.71	.103/2.62	.500/12.70	.500/12.70	.218/5.54
RLE-5-F	E5	.181/4.60	.127/3.23	.625/15.88	.500/12.70	.260/6.60
RLE-6-F	E6	.219/5.56	.151/3.84	.625/15.88	.500/12.70	.297/7.54
RLE-7-F	E7	.237/6.02	.166/4.22	.750/19.05	.750/19.05	.437/11.10
RLE-8-F	E8	.288/7.32	.201/5.11	.750/19.05	.750/19.05	.562/14.27
RLE-10-F	E10	.363/9.22	.260/6.60	1.000/25.40	1.000/25.40	.732/18.59
RLE-12-F	E12	.432/10.97	.304/7.72	1.000/25.40	1.000/25.40	.957/24.31
RLE-14-F	E14	.500/12.70	.355/9.02	1.250/31.75	1.000/25.40	1.070/27.18
RLE-16-F	E16	.572/14.53	.405/10.29	1.250/31.75	1.000/25.40	.852/21.64
RLE-18-F	E18	.645/16.38	.460/11.68	1.250/31.75	1.000/25.40	1.150/29.21
RLE-20-F	E20	.715/18.16	.512/13.00	1.500/38.10	1.500/38.10	1.300/33.02

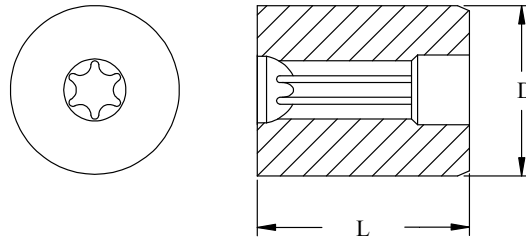

Stem Style

Part Number	Drive Size	A inch/mm	B inch/mm	D inch/mm	L inch/mm	X Choke inch/mm
RLE-4-S	E4	.146/3.71	.103/2.62	.500/12.70	.500/12.70	.167/4.242
RLE-5-S	E5	.181/4.60	.127/3.23	.625/15.88	.500/12.70	.215/5.46
RLE-7-S	E7	.237/6.02	.166/4.22	.750/19.05	.750/19.05	.274/6.96
RLE-8-S	E8	.288/7.32	.201/5.11	.750/19.05	.750/19.05	.332/8.43
RLE-10-S	E10	.363/9.22	.260/6.60	1.000/25.40	1.000/25.40	.403/10.24
RLE-12-S	E12	.432/10.97	.304/7.72	1.000/25.40	1.000/25.40	.465/11.81
RLE-14-S	E14	.500/12.70	.355/9.02	1.250/31.75	1.000/25.40	.563/14.30
RLE-16-S	E16	.572/14.53	.405/10.29	1.250/31.75	1.000/25.40	.680/17.27
RLE-18-S	E18	.645/16.38	.460/11.68	1.250/31.75	1.000/25.40	.705/17.91
RLE-20-S	E20	.715/18.16	.512/13.00	1.500/38.10	1.500/38.10	.798/20.27

1. Material 25% Carbide.
2. Carbide Insert supplied only when ordered.
3. Specify if lapped extruding land is required when ordering. Extra charge applies.

RTM PRODUCTS, INC.
13120 Arctic Circle, Santa Fe Springs, CA 90670 USA
Phone: 562-926-2400 Fax: 562-926-2441 www.rtmproducts.com